

Brighton & Hove Open Door 2016

8 – 11 September

PROGRAMME

90 FREE EVENTS celebrating the City's heritage

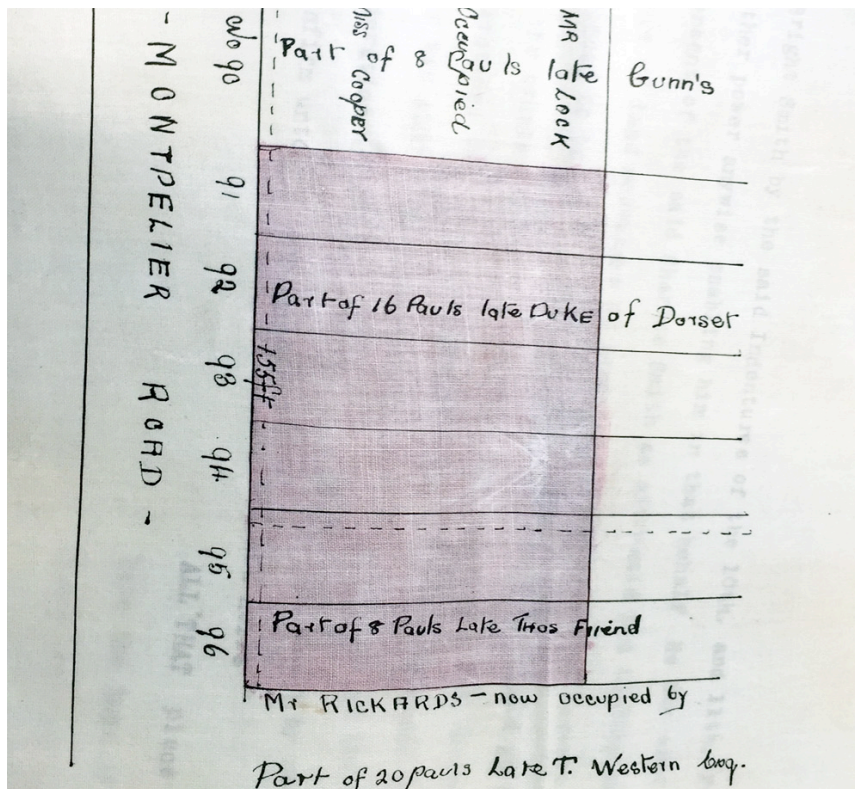

Contents

| | | |
|-------------------------|---------------------------------|------------|
| General Category | Open Door and Pre-booked events | Page 3-4 |
| My House My Street | Open Door and Pre-booked events | Page 4-5 |
| Here in the Past | Open Door and Pre-booked events | Page 5 |
| Walks | Open Door and Pre-booked events | Page 5-8 |
| Religious Spaces | Open Door and Pre-booked events | Page 8-11 |
| Fashionable Houses | Open Door and Pre-booked events | Page 11-12 |
| Silhouette History | Open Door and Pre-booked events | Page 12 |
| Industrial & Commercial | Open Door and Pre-booked events | Page 12-14 |
| Education | Open Door and Pre-booked events | Page 14-15 |
| Garden & Nature | Open Door and Pre-booked events | Page 15 |
| Art & Literature | Open Door and Pre-booked events | Page 15 |
| Theatre & Cinema | Open Door and Pre-booked events | Page 15-16 |
| Archaeology | Open Door and Pre-booked events | Page 16 |
| Architecture | Open Door and Pre-booked events | Page 17 |

About the Organisers

Brighton & Hove Open Door is organised annually by staff and volunteers at The Regency Town House in Brunswick Square, Hove.

The Town House is a grade 1 Listed terraced home of the mid-1820s, developed as a heritage centre with a focus on the city's rich architectural legacy.

Work at the Town House is supported by The Brunswick Town Charitable Trust, registered UK charity number 1012216.

About the Event

Brighton & Hove Open Door is always staged during the second week of September, as a part of the national Heritage Open Days (HODs) – a once-a-year chance to discover architectural treasures and enjoy tours and activities about local history and culture. The Town House team have participated in HODs since its inception in 1994.

When using this guide, please note that we have set out the listings in 14 thematic categories and that within each category we have provided first the events that do not require pre-booking and then the venues and activities that do require booking*. Where booking is required, this can be done via The Regency Town House website (www.rth.org.uk/BHOD16) or via 01273 206206.

We hope you find the thematic categories useful but do please bear in mind that they are somewhat arbitrary and that you may find activities of interest in unexpected listings.

This year we have several fabulous new events at the centre of our BHOD offer, including tours of, Shoreham Lifeboat Station, Sussex County Cricket Club, and Brighton's Palace Pier.

This year we continue to offer events focused on the history and residents of local areas, (for further details see: www.MyHouseMyStreet.org.uk and www.HereInThePast.org.uk)

If you would like to assist us with the organisation of future Brighton & Hove Open Door events, if you would like to participate as a venue or activity organiser, or if you have suggestions for improvements, do please contact us via:

The Regency Town House, 13 Brunswick Square, Hove, BN3 1EH, Tel. 01273 206306 / email: bhod@rth.org.uk

Thanks

During 2016 we have continued our efforts to establish Brighton & Hove Open Door as one of the city's great annual celebrations.

This year's programme is testimony to the hard work of the many people involved in organising the event and we are grateful to them all, especially our Town House volunteers and the venue and activity organizers; who are giving so generously of their time.

Nick Tyson, Curator, The Regency Town House

- Please Note: Events that must be pre-booked, prior to attendance, can be reserved online at: <http://www.rth.org.uk/BHOD16> or via 01273 206206. All places are allocated on a first-come-first-served basis. For full details of all events see the website listed immediately above.

Brighton & Hove Open Door – great days out for free!

GENERAL CATEGORY

Open Door - no booking required

The Orange Lilies - Brighton and Hove in the Somme

Mezzanine Level, 8 Marshalls Row, Open Market, Brighton & Hove, East Sussex, BN1 4JU

Strike a Light, in partnership with Brighton & Hove Library and Information Service and Fabrica, showcases its WWI themed project The Orange Lilies – Brighton and Hove Soldiers in the Somme.

Opening Times:

Friday 9 September: 1300-1900

Saturday 10 September: 1300-1700

The Preston Manor dog cemetery and Edwardian walled garden

Preston Manor, Preston Park, Brighton & Hove, East Sussex, BN1 4AT

A tour celebrating the happy lives and poignant deaths of Victorian and Edwardian family dogs immortalised in the famous pet cemetery at Preston Manor.

Thursday 8 September: Tour: 11.30- 12.30

Booking required

BBC Studio Tours

BBC Studios, 40 - 42 Queens Road, Brighton & Hove, East Sussex, BN1 3XB

A behind the scenes peek at the BEEB. The Queens Road studios are the home of BBC Sussex. Broadcasting across the County and into Surrey and north-east Hampshire the station is the BBC's largest outside of London.

Opening Times:

Friday 9 September: Tour 1400 - 1500

Brighton Dome

Brighton Dome, Church Street, Brighton & Hove, East Sussex, BN1 1UG

We'll be celebrating the rich heritage of our Grade I and II listed buildings as we fling open our doors for our fourth annual Heritage Open Day of free family entertainment.

Opening Times:

Sunday, 11 September: 10.00 -17.00

The main site is free to explore but tours, talks, and magic lantern shows must be pre booked.

Booking Details:

Please email heritage@brightondome.org

Full schedule details are listed on the Brighton

Dome website: <http://www.brightondome.org>

Brighton Old Police Cells

Meet at the main entrance to Brighton Town Hall, Bartholomew Square, Brighton & Hove, East Sussex, BN1 1JA

The Old Police Cells Museum is housed in the basement of Brighton Town Hall and offers visitors a unique insight into the history of policing in Sussex.

Thursday 8 September: Tours 10.00, 12.00 & 14.00

Friday 9 September: Tours 10.00, 12.00 & 14.00

Saturday 10 September: Tours 10.00 & 12.00

Keep the Home Fires Burning

Fabrica, 40 Duke Street, Brighton & Hove, East Sussex, BN1 1AG

Join us for this special drop-in event, to explore and contribute to our local heritage project, The Boys on the Plaque! Find out about remarkable young men who lived in our city and fought in the war 100 years ago, and the discoveries we've made about their experiences, families and legacies.

Opening Times:

Thursday 8 September, 13.00 - 16.00

Booking Contact: Clare Hankinson

Call: 01273 778646

Email: clare.hankinson@fabrica.org.uk

Saltdean Lido – a modernist marvel on the Sussex Coast

Saltdean Park Road, Saltdean, Brighton & Hove, East Sussex, BN2 8SN

Saltdean Lido was built in 1938 by R.W.H. Jones in the 'International Style'. With its distinctive gull wings and famous rotunda, its design epitomizes some of the best elements of the British modernist movement. In 2015 Historic England named it as 'One of the 7 wonders of the English Seaside'.

Friday 9 September: Tours 10.30 – 11.00, 11.30 – 12.00, 12.30 – 13.00, 13.30 – 14.00

Saturday 10 September: Tours 11.00 -11.30, 12.00 – 12.30, 13.00 – 13.30

Directions:
By Bus from Brighton – 27, 14, 12 (stop – Longridge Avenue, Saltdean

Sussex County Cricket Club - Tour of the Ground

Sussex County Cricket Club, Eaton Road, Brighton & Hove, East Sussex, BN3 3AN

Sussex County Cricket Club was the first First-Class County formed in 1839 and is the oldest professional sports team in the world. This is the first time this has been offered during the Heritage Open Days. Worksheets suitable for 8-10 year old children will be available.

Tour lasts approx 1 hour

Opening Times:
Friday 9 September: Tours 10.30-11.30, 12.00-13.00, 14.00-15.00, 15.30-16.30

Directions:
Meet outside the club reception.

MY HOUSE MY STREET **Open Door - no booking required**

Architecture & Materials - from Bungarooch to Iron and Beyond

Meet at the corner of Robert Street and North Road, North Laine, Brighton & Hove, East Sussex

Come and discover Robert Street's fascinating story and gain an insight into Brighton's unique history.

Sunday 11 September: Walk 13.00-14.00

Discover the MyHouseMyStreet project

Meet at the corner of Gloucester Road and Sydney Street, North Laine, Brighton & Hove, East Sussex

The MyHouseMyStreet project documents Brighton & Hove's historic properties and residents. If you'd like to discover more about the history of exactly where you live, don't miss this opportunity to Discover the MyHouseMyStreet project!

Opening Times:
Sunday 11 September: 11.00-14.00

Pelham Square - A new look at an old square!

Meet at the red telephone boxes at the corner of Pelham Square, Brighton & Hove, East Sussex.

For BHOD 2016, come and join a member of the MyHouseMyStreet research team on an architectural assessment of Pelham Square. We will be looking at some of the Square's more interesting architectural features and discovering Pelham Square's fascinating story, giving us an insight into Brighton's unique history.

Opening Times:
Sunday 11 September: meet 14.20 (Tour 14.30-15.15)

Booking required

Not Just the Trunk Murders!

A MyHouseMyStreet illustrated walk in Kemp Street. Meet at the south end of Kemp Street, Brighton & Hove, East Sussex.

Kemp Street has long had a notorious place in Brighton's history with the infamous Trunk Murders of 1934. Find out about this and more fascinating stories in this street's past, including the story of the last large-scale smallpox outbreak in England.

The MyHouseMyStreet initiative is a collaborative, community-based project providing in-depth local street histories in Brighton. For further information, see: www.mhms.org.uk.

Opening Times
Sunday 11 September: Tour starts at 3pm

Sex and Shopping!

A MyHouseMyStreet guided walk

Meet at the junction of Gardener St and Church St, outside Gelato Gusto ice cream parlour, Brighton & Hove, East Sussex, BN1 1UP

Join us for a guided tour of Gardner Street and neighbouring Orange Row (all that remains of the once infamous Pimlico district of Brighton). The walk will last a maximum of one hour and will aim to highlight 200 years of the streets' somewhat chequered history.

Opening Times
Sunday 11 September: meet 11.55 or 13.55.

Society, Schools, & Slaughterhouses

A MyHouseMyStreet guided walk

Meet at the North side of Pelham Square, Brighton & Hove, East Sussex, BN1 4ET,

Explore the rich history behind the jumbled facades of Trafalgar Street, from open fields to Conservation Area. Along the way we'll meet scholars and shopkeepers, pubs and philanthropists, council control and yes, cows.

Opening Times

Sunday 11 September: 13.00

HERE IN THE PAST

Open Door - no booking required

Discover the Here in the Past Project

Corner of Gloucester Road and Sydney Street, North Laine, Brighton & Hove, East Sussex

Our new Here in the Past project further documents Brighton & Hove's historic properties and residents, taking in houses and peoples across many areas not covered by our MHMS initiative. Come along and take away information explaining how to learn more about your own home or street.

Opening Times:

Sunday 11 September: 14.00 – 16.00

Here in the Past - Brunswick Town

The Regency Town House, 13 Brunswick Square, Brighton & Hove, East Sussex, BN3 1EH

We are working on the Brunswick Town area at the moment and this is a chance to get a taste of discoveries to date!

Opening Times:

Friday 9 September: 16.00 - 17.30

Here in the Past - Dean Street

Stand location: Outside the The Brighton Beer Dispensary, 38 Dean Street, Brighton & Hove, East Sussex, BN1 3EG

We are working on the Dean Street area at the moment and this is a chance to get a taste of discoveries to date!

Opening Times:

Friday 9 September: 16.00 - 17.30

Here in the Past - Local Stories

The Regency Town House, 13 Brunswick Square, Brighton & Hove, E. Sussex, BN3 1EH

Our new Here in the Past project is documenting Brighton & Hove's historic properties and residents, taking in houses and peoples from across the city. Come along and discover our Here in the Past - Local Stories Exhibition

Opening Times:

Friday 9 September: 14.00 – 16.00

Here in the Past - Montpelier

Stand location: Front garden of No. 96 Montpelier Road, Montpelier Road, Brighton & Hove, East Sussex, BN1 3BE

We are working on the Montpelier area at the moment and this is a chance to get a taste of discoveries to date, including information about Montpelier Road and Montpelier Villas.

Opening Times:

Friday 9 September: 18.00 - 19.30

Here in the Past - Poet's Corner

Stand location: Corner of Coleridge Street and Sheridan Terrace, Brighton & Hove, East Sussex, BN3 5AB

We are working on the Poet's Corner area at the moment and this is a chance to get a taste of discoveries to date!

Opening Times:

Thursday 8 September: 18.00 - 19.30

Here in the Past - Port Hall

Corner of Port Hall Street and Port Hall Road, Brighton & Hove, East Sussex, BN1 5PJ

We are working on the Port Hall area at the moment and this is a chance to get a taste of discoveries to date!

Opening Times:

Thursday 8 September: 16.00 - 17.30

WALKS

Open Door - no booking required

Beanfields to Bohemia Walk - North Laine

Meet Brighton Museum Entrance, Royal Pavilion Gardens, Brighton & Hove, East Sussex, BN1 1EE

Join local historian Dr Geoffrey Mead for a 2-hour stroll through the streets of the North Laine conservation area looking at aspects of historical and contemporary interest. Starts promptly. Children welcome when accompanied by an adult.

Saturday 10 September: Walk: 10.00 – 12.00

Boys on the Plaque Walking Tour with Historian Dr Geoffrey Mead

Fabrica, 40 Duke Street, Brighton & Hove, East Sussex, BN1 1AG

Led by local historian Dr Geoffrey Mead, this will be a unique Walking Tour of Brighton's historic The Lanes and North Laine area. Exploring the stories of local soldiers that we have discovered as part of a local heritage project, we get to know the young men who lived in these streets over 100 years ago, before joining a war that took them far from home.

Opening Times:

Friday 9 September Walk: 18.00-19.30

BRIGHTON 1889-1914 - Possibly The Greatest 25 Years in the History of Mankind?

Meet at foot of Madeira lift, 286A Madeira Drive, Brighton & Hove, East Sussex, BN2 1EN

Join Duncan Cameron for a two hour guided walk This was the period when Brighton was at its peak. It was at the forefront of the new electric based technologies of the time and was the "place to be". We shall show how this is reflected along the seafront between Madeira Drive to West Street.

Sunday 11 September: Walk: 15.00 – 17.00

Brighton beach linear walk

Meet: Brighton Palace Pier, Madeira Drive, Brighton & Hove, East Sussex, BN2 1TW

Brighton beach has a mix of human activities from fishing to nightclubs but also a range of natural features, pebbles and waves, gulls and sand. A linear walk from the Palace Pier west to the Hove border. Event not suitable for children under the age of 5.

Saturday 10 September: Walk: 16.00 – 18.00

Brighton's hidden gem - West Hill

St Nicholas Church, Church Street, Brighton & Hove, East Sussex, BN1 3LJ

Near the Seven Dials is Brighton's secret gem - West Hill. Join local historian Dr Geoffrey Mead for a stroll through narrow twittens and grand buildings, great views and hidden gardens. Event not suitable for children under the age of 5.

Sunday 11 September: Walk: 16.00 - 18.00

Down on the border: Norfolk Square

Norfolk Square bus stop, Western Road, Brighton & Hove, East Sussex, BN1 2AA

Norfolk Sq lies on the former Brighton & Hove parish border; this walk weaves to and fro through the borderland between seafront and Western Rd, a landscape of grand architecture and the 'Zone in Transition' Event not suitable for children under the age of 5.

Saturday 10 September: Walk: 13.00 – 15.00

Hove (actually) tour - Brighton's better half

Meet at The Regency Town House, 13 Brunswick Square, Brighton & Hove, East Sussex, BN3 1EH

Modern Hove has a much more genteel reputation than its noisy big brother but its long history has been anything but quiet. Join Nick Richmond on a walk around Hove and discover -

- Ancient burial mounds in Palmeira Avenue
- The mysterious Goldstone, relic of the Druids
- Bull fighting in the town and the one that got away!
- Beach battles with the smugglers, and more besides

Saturday 10 September: Tours: 11.00 – 12.00 & 15.00 – 16.00

Sunday 11 September: Tours: 11.00 – 12.00 & 15.00 – 16.00

Preston Park - History Tour

Florianas Rotunda Cafe, Preston Park, Preston Road, Brighton & Hove, East Sussex, BN1 6HN

Ever wondered about the history of Preston Park - the biggest and first municipal park in the city? This Illustrated History of Preston Park Walk will take you on a journey from Roman times to the present day. Event not suitable for children under the age of 10.

Saturday 10 September: Tour: 14.30 – 16.00

Preston Rock Garden

Preston Rock Garden, Preston Road, Brighton & Hove, East Sussex, BN1 6SD

New for 2016! Come and celebrate the 80th birthday of Preston Rock Gardens with a 90 minute guided tour from Andy, the head gardener. Learn about the history and plans for the future for this lovely garden.

Opening Times:

Thursday 8 September: 12.00 – 13.30

Friday 9 September: 12.00 – 13.30

Saturday 10 September: 12.00 – 13.30

Access Information:

There are a few steps in the lower area of the garden but we can generally get by even with wheelchairs. The entire tour is conducted at the front of the garden so there are no steep paths to climb.

Regency Square - The Pleasure of Leisure

Meet at North end of Regency Square, beside the Heritage Board, Regency Square, Brighton & Hove, East Sussex, BN1 2EF

Join Duncan Cameron for a ninety minute guided walk showing how the area has developed in response to leisure needs. Regency Square and its surroundings was created as a place in which to have fun. We shall see how that has played out up to the present.

Saturday 10 September: Walk 11.00 – 12.30

Two sides to every valley

Meet Brighton Museum Entrance, Royal Pavilion Gardens, Brighton & Hove, East Sussex, BN1 1EE

Two sides to every valley- a walk with Dr Geoffrey Mead. An exploration of the Valley Gardens area of central Brighton. Event not suitable for children under the age of 5.

Sunday: 10.00-12.00

Access Information:

This walk will involve some steep Brighton hills and some tiny alleys.

Booking required

Commemorative Plaque Trail 1 - Sealife Centre to the Marina

Meet at Harry Ramsden's, 1-4 Marine Parade, Brighton & Hove, East Sussex, BN2 1TA

There are nearly 100 commemorative plaques in the city of Brighton and Hove. Placed by various bodies - the Council and The Regency Society amongst them. Until recently there was no definitive record of these plaques, but now there is the Regency Society's survey and Plaque Trail publications. This event is designed to encourage awareness of these documents. Join a representative from The Regency Town House project for a gentle journey around the above trail. Each participant will receive a free copy of the trail route, upon arrival at the start point. Allow an hour or so.

Friday 9 September: Walk: 09.30

Access Information: This trail will take you along Marine Parade and up some side streets. There are one or two steepish bits, but most of the walk is on fairly level ground.

Commemorative Plaque Trail 2 - The Floral Clock Circular

Start at top of Palmeira Square at the Floral Clock, Brighton & Hove, East Sussex

Allow an hour or so to complete this event.

Friday 9 September: 13.00

Commemorative Plaque Trail 3 - The Old Town of Brighton

Start at Old Steine, northeast corner of St James' Street, Brighton & Hove, East Sussex

Allow an hour or so for the plaques walk, and perhaps some time for the shops and restaurants at the end!

Friday 9 September: 11.00

Regency Ramble with the Brighton and Hove Urban Ramblers

Velo Cafe, The Level, Ditchling Road, Brighton & Hove, East Sussex, BN1 4ZN

A ramble through some of the best of Regency architecture in Brighton and Hove and ending with a tour of the basement of The Regency Town House to see how people lived 'downstairs' in the early 1800s.

We'll walk towards the Steine and the seafront, coming back inland again for Russel Square, Clarence Square and Canon Place. Up the hill from here to Powis and Montpelier Villas to lead us on to Regency Square and into the regency grandeur of Hove, and ending at Regency Town House for the tour by its curator, Nick Tyson.

The walk will take around three hours and will allow for a tour of the basement from 15:00 to see how the restoration is progressing. Event not suitable for children under the age of 5.

Sunday 11 September: Walk: 12.00 – 16.00

The Brunswick Town Walk

Start at Regency Town House, 13 Brunswick Square, Hove, Brighton & Hove, East Sussex, BN3 1EH

Join us for a gentle 90-minute guided walk around historic Brunswick Town, designed as a Regency new town in the 1820s by the architect Charles Augustin Busby.

Thursday 8 September: Tour: 11.30

The Development of North Laine as Brighton's Industrial and Commercial Suburb

Meet at the entrance to Brighton Museum, Royal Pavilion Gardens, Brighton & Hove, East Sussex, BN1 1EE

Join Peter Crowhurst, chair of the North Laine Community Association for a wander through the streets and twittens of North Laine to Trafalgar St and then back to Church St.

The tours will last approx 90 minutes.

Sunday 11 September: Tours 11.00 – 12.30 & 15.00 – 16.30

Thomas Kemp and his Grand Design

Meet at junction of Lewes Crescent and Chichester Terrace, Brighton & Hove, East Sussex, BN2 1FG

A look at the history, architecture and notable residents of the Kemp Town Estate since 1826 exploring Thomas Kemp's grand design.

The tour will conclude with a visit to the enclosures and a walk through the tunnel onto the seafront.

Saturday 11 September; Walk: 14.00 – 15.00

RELIGIOUS SPACES

Open Door - no booking required

All Saints' Church Guided Tour

Junction The Drive / Eaton Road, Hove, Brighton & Hove, East Sussex, BN1 1UF

All Saints stands as one of the finest churches of the 19th century Gothic Revival and the creation of two remarkable men: Thomas Peacey, the first Vicar of modern-day Hove, and John Loughborough Pearson, one of the principal architects of the period. It has always been highly regarded as a building: Nikolaus Pevsner described it as 'superb and cathedral-like'.

Saturday 10 September: Tours 10.30 – 11.15 & 11.30-12.15

Sunday 11 September: Tour 13.00 – 13.45

Brighton Quakers Meeting House

Friends Meeting House, Ship Street, Brighton & Hove, East Sussex, BN1 1AF

Come and visit the Quaker Meeting House and 19th century adult education centre where there will be an exhibition telling the story of Brighton's Quaker community from 1655 and the history of the Friends' Meeting House which was built in 1805. Visitors will be able to purchase books on the history of Brighton Quakers and postcards.

Opening Times:

Saturday 10 September: 10.00 – 17.00

Brighton Unitarian Church

Unitarian Church, New Road, Brighton & Hove, East Sussex, BN1 1UF

The church was built in 1820 on land purchased from the Prince Regent.

The congregation dates from 1793. The church building was completed in August 1820. Dr Morell, a well-known classical scholar, was appointed as the first minister of the church. Due in large part to his influence, the design of the church was inspired by the ancient Temple of Theseus in Athens. It was designed by well-known local architect Amos Henry Wilds – who built much of Brighton's fashionable Kemp Town.

Opening Times:

Thursday 8 September: 10.00 – 16.00

Middle Street Synagogue - Brighton

Synagogue, Middle Street, Brighton & Hove, East Sussex, BN1 1AL

In 1874, a project for a new synagogue in Brighton was put out to tender. It was won by Thomas Lainson, a well-known local architect and the new synagogue opened in 1875. The exterior has been described as both Byzantine and Romanesque and looks slightly out of

place in its side street home. The interior was described by Anthony Dale as amongst the most splendid synagogue interiors in Europe. It certainly is quite spectacular but was originally fairly plain, but between 1880-1915, donations gradually furnished the building with wrought iron, brass work and stained glass. The building has recently been nominated for the European Routes of Jewish Heritage as one of Britain's Top Ten Synagogues.

In this, the 250th year of Brighton Jewry, we will host an open house event from 12 noon until 4pm on the Sunday. People will be on hand to answer questions and the special 250th Anthology will be available for purchase.

Sunday 11 September: 12.00-16.00

St Andrew's Chapel, Hove

Waterloo Street, Hove, Brighton & Hove, East Sussex, BN3 1AQ

Set back from the seafront, this Regency church was built to serve the expanding resorts of Hove and Brighton. Designed in 1827 by the famous architect Sir Charles Barry, its Italian Renaissance style perfectly matches the symmetry and grandeur of the neighbouring squares and terraces. Cared for by The Churches Conservation Trust and no longer used for worship, it is now sometimes used as a community venue.

Sunday 11 September: 14.00 – 16.00

St Andrew's Old Church, Hove

Church Road, Hove, Brighton & Hove, East Sussex, BN3 2AD

St Andrew's Old Church in Church Road, Hove, served as Hove's parish church for many centuries. However by the early 19th century the structure was in a state of near ruin. It was rebuilt in 1836 as nearly as possible to its original design and the interior of the church between the pillars is contemporary with the original foundations. It is hoped that the Late Summer Fayre will be on during Saturday afternoon but please check first.

Opening Times:

Thursday 8 September: 09.00 – 12.00

Friday 9 September: 09.00 – 12.00

Saturday 10 September: Late Summer Fayre 12.00 – 15.00

St Bartholomew's Church

Ann Street, Brighton , Brighton & Hove, East Sussex, BN1 4GP

St Bartholomew, Brighton, one of the great churches of the 19th century - the cathedral of what used to be called the 'London-Brighton and South Coast Religion' with its incense, ritual, embroidered vestments and lights. The fabric itself is a masterpiece of brickwork and a credit to its little-known architect, Edmund Scott.

Opening Times:

Thursday 8 September: 10.00 – 16.30

Friday 9 September: 10.00 – 16.30

Saturday 10 September: 10.00 – 16.30

Sunday 11 September: 09.00 – 13.00

Access Information:

On Sunday there will be two main services in progress at 9.30 am and 11.00am and there are services on the other weekdays which any visitors must be considerate of.

St Helen's Open Days and "Bounty of Nature" Exhibits

St Helen's Church, Hangleton

Way/Downsview, Brighton & Hove, East Sussex, BN3 8ER

Listed Grade II, St Helen's has parts variously dated to Late Saxon to Early Norman, It does not feature in Domesday, but certainly was in existence by 1093. The Tower was added c. 1300 along with a re-modelling of the Chancel. The decline of the village after the black death in the mid 14th century to a population of less than 100 which level remained until the 20th century was probably responsible for saving St Helen's from the Victorian 'restorers'.

Opening Times

Friday 9 September: 10.30 – 16.00

Saturday 10 September: 10.30 – 16.00

Sunday 11 September: 12.30 – 16.00

Additional information:

There will be an exhibition in words and text of the history of the church and its immediate surroundings. Also we are having a small competition of exhibits called "Bounty of Nature" hopefully with entries from local groups, schools or individuals which will be displayed in the church.

St John the Baptist Church, Hove

St John the Baptist Church, Palmeira Square, Brighton & Hove, East Sussex, BN3 2BW

The church will be open, with details of its history and architecture and a related heritage quiz sheet. Musical entertainment, including on our wonderful 1902 Walker organ (virtually

unaltered since it was built) and refreshments will be available during the day.

Opening Times:

Saturday 10 September: 10.00 – 16.00

Access:

We are 5 minutes walk from the Queen Victoria Statue, where The Drive meets the seafront. There is very little parking available near the church. Nearest NCP car park is about 5 minutes' walk away in Norton Road (BN3 3BE). All on-street parking is metered.

St Leonard's Church, Aldrington

St Leonard's Church, 211 New Church Road, Brighton & Hove, East Sussex, BN3 4DB

St Leonard's Church is one of the two churches in the Parish of Aldrington, the other being St Philip's about a mile to the east on New Church Road which you can visit while you're in the area.

We will operate an 'open door', but there will be people around to answer questions and guide people to toilets etc.. Both churches will offer refreshments and home made cakes.

Opening Times:

Saturday 10 September: 10.00 – 16.00

St Mary's Kemp Town - Visit the church and meet a stone mason

Upper Rock Gardens, Brighton, Brighton & Hove, East Sussex, BN2 1PR

St Mary's Church was built in 1876–8 to designs by Sir William Emerson, PRIBA, and is his only surviving church in Britain. The modest brick exterior conceals an interior of surprising volume and warmth, which reflects Emerson's training under William Burges, the great Gothic Revivalist, but also the Indo-Islamic influences of a career spent largely in India, where he most famously built the Victoria Memorial in Calcutta (Kolkata).

Come and meet a banker mason from Pierra Restoration who is helping to repair decayed stonework at St Mary's Church. A banker mason specialises in cutting and shaping stone to precise requirements. You will be able to watch the mason at work and ask about the tools and skills involved in the trade. One of our conservation architects will also be on hand to answer questions.

Opening Times:

Saturday 10 September: 1100 - 1600

St Nicholas' Church, Brighton

Dyke Road, Brighton, Brighton & Hove, East Sussex, BN1 3LJ

This church is dedicated to St Nicholas, the patron saint of sailors and fishermen. Until 1873, St Nicholas was the Parish Church of Brighton and it still is the Mother Church and the only church in central Brighton of ancient interest.

Opening Times:

Friday 9 September: 13.00 – 15.00

Saturday 10 September: 10.00 – 17.00

Sunday 11 September: 13.00 – 15.00

Access Information:

Access for Wheelchairs through North-East and South doors by arrangement.

St Nicholas' Church, Portslade

South Street, Portslade, Brighton & Hove, East Sussex, BN41 2LE

St Nicolas Portslade was built around 1170 - but since then almost every generation have done things to the building to better suit the needs of the worshipping community - including adding a "weeping" chancel and bell tower around 1250; a north aisle and pews in the 1850s; a choir gallery in 1932.

Opening Times:

Thursday 8 September: 08.30 – 17.00

Friday 9 September: 08.30 – 17.00

Saturday 10 September: 08.30 – 17.00

Sunday 11 September: 09.30 – 17.00

St Paul's Church

West Street, Brighton , Brighton & Hove, East Sussex, BN1 2RE

St Paul's is one of the most impressive churches in Brighton and its construction in 1846-48 signified the final victory of the gothic style. The building has the largest collection of Pugin stained glass in the Church of England. Join us for a guided tour of the building to see this magnificent legacy as well as windows by Kempe.

St Paul's is also home to Safe Space, a rescue point operated on Friday and Saturday by the YMCA and Red Cross, to help those in need on those evenings. Street Pastors are also based at St Paul's.

Opening Times:

Thursday 8 September: 10.30 – 15.00

Friday 9 September: 12.00- 15.00

Saturday 10 September: 10.00 – 17.00

St Peter's, Preston Park

Preston Drive, Brighton, Brighton & Hove, East Sussex, BN1 6SD

This simple 13th century flint church makes a pleasing medieval contrast with its suburban surroundings. It is notable for the substantial area of 14th century wall paintings and is in the care of The Churches Conservation Trust. An exhibition of 'Brighton and St. Peter's' in 1916 will be on display on Saturday 10th and Sunday 11th September.

Opening Times:

Saturday 10 September: 10.30 -15.30

Sunday 11 September: 1030-1530

St Peter's Church, West Blatchington

St. Peters Church, Hangleton Road, Brighton & Hove, East Sussex, BN3 7LQ

St Peter's Parish Church, West Blatchington, has been in existence in some form since Saxon times and some original Norman construction is still in evidence as are some stained glass windows from the 'old church'. 2016 marks the 125th anniversary of the rededication of the church following completion of restoration in 1891. Why not pay a visit to the church as well as West Blatchington Windmill, next door, and St Helen's church, Hangleton, a short walk away.

Opening Times

Sunday 11 September: 15.30 – 17.00

St Philip's Church, West Hove

St. Philips Church, New Church Road, Brighton & Hove, East Sussex, BN3 4BB

St Philip's Church is situated in New Church Road, Hove. It is one of two churches in the Parish of Aldrington, the other being St Leonard's, about a mile to the west on New Church Road which you can visit while in the area. We will operate an 'open door', but there will be people around to answer questions and guide people to toilets etc. At St Philip's there will be a Church Mouse Trail for youngsters with prizes for completed trails. Both churches will offer refreshments and home made cakes.

Opening Times:

Saturday 10 September: 10.30 – 12.30

Sunday 11 September: 14.30 – 17.00

Stanmer Church: Meet the Michelbournes

Stanmer Village Church, Stanmer, Brighton & Hove, East Sussex, BN1 9PZ

Steve Kisko: Meet the Michelbournes. Come and find out about this Sussex family, who owned Stanmer before the Pelham family, and their wider connections across the county.

Opening Times:

Sunday 11 September Church: 14.30 – 15.30,

ALSO: Walk: 15.30 – 16.00 Ann Markwick

provides an introduction to the Stanmer Village History Trail. Stout footwear and suitable outdoor clothing is recommended for the walk.

FASHIONABLE HOUSES

Open Door - no booking required

33 Palmeira Mansions (The English Language Centre)

33 Palmeira Mansions, Corner of Salisbury Road and Church Road, Brighton & Hove, East Sussex, BN3 2GB

This Grade II* listed Victorian house is now part of the English Language Centre. The building has a magnificent Victorian interior, including a marble staircase, alabaster tiled walls, marble dados and many extraordinary fireplaces with elaborate overmantels, these being described in the listing as 'an outstanding collection of fittings'.

Opening Times:

Saturday 10 september: 11.00 – 16.00

Booking required

37 Kensington Place Tour

CANCELLED DUE TO UNFORSEEN BUILDING WORKS

Clayton Tunnel North Portal

Tunnel House, Clayton Hill, Clayton, Brighton & Hove, East Sussex, BN6 9PQ

Every day hundreds of trains hurtle under this Gothic folly whose imposing castellated towers protect the old tunnel keeper's cottage. But for most people this secluded building remains a mystery. What are its historical origins? What lies behind the commanding battlements? And what's it like having trains running right beneath your living room?

NOTE: due to space limitations, no one will be granted access unless they hold a confirmed booking.

Saturday 10 September: Tour: 14.00 & 16.00

Sunday 11 September: Tour: 14.00 & 16.00

Access Information:

NOTES: Access to Tunnel Cottage grounds is via a gravel track and rutted earth paths and therefore not suitable for wheelchairs. We regret that we cannot admit anyone under the age of 18. Visitors should bring an umbrella should rain be likely since the grounds are exposed. We regret that we cannot admit anyone under the age of 18. Due to space limitations, no one will be granted access unless they hold a confirmed booking.

Embassy Court, Icon of 20th Century Modernism

*King's Road, Corner of Western Street,
Brighton & Hove, East Sussex, BN1 2PX*

Embassy Court was designed by the Canadian architect Wells Coates and completed in 1936. The following year, the Museum of Modern Art in New York featured the building in its seminal exhibition 'Modern Architecture in England', arguing that the UK was at the forefront of Modernism and Embassy Court the epitome of everything desirable in modern architecture.

90 minute tour of this iconic 1930's Modernist apartment block on Brighton seafront

Opening Times:

Thursday 8 September: Tour 11.00 to 12.30

Friday 9 September: Tour 11.00 to 12.30

Saturday 10 September: Tour 11.00 to 12.30

Sunday 11 September: Tour 11.00 to 12.30

The Regency Town House Tour

*13 Brunswick Square, Hove, Brighton & Hove,
East Sussex, BN3 1EH*

Join us for a 90-minute tour around one of the city's finest 1820s terraced town houses, currently being restored as a heritage centre for Brighton & Hove.

Opening Times:

Thursday 8 September: 09.30

SILHOUETTE HISTORY

Booking required

Discovering the Silhouette Machine - Kid's Workshop

The Regency Town House, 13 Brunswick Square, Brighton & Hove, East Sussex, BN3 1EH

200 year ago a series of intriguing 'machines' were invented to make portrait silhouettes. Come along and learn about the history and use of these devices, make some portraits and

take them home with you. Event not suitable for children under the age of 8.

Opening Times:

Thursday 8 September: 16.00 – 17.00

Discovering the silhouette machine, adult's workshop

The Regency Town House, 13 Brunswick Square, Brighton & Hove, East Sussex, BN3 1EH

200 year ago a series of intriguing 'machines' were invented to make portrait silhouettes. Come along and learn about the history and use of these devices, make a portrait and take the image home with you.

Opening Times:

Thursday 8 September: 15.00 – 15.45

Profiles of the Past - 250 years of British Portrait Silhouette History

The Regency Town House, 13 Brunswick Square, Brighton & Hove, East Sussex, BN3 1EH

Come along and spend 45 minutes discovering the 'Profiles of the Past' initiative, developing a website about British portrait silhouette history. Event not suitable for children under the age of 7.

Opening Times:

Thursday 8 September: 14.00 – 14.45

INDUSTRIAL & COMMERCIAL **Open Door - no booking required**

Ale and Hearty Exhibition

Mezzanine Level, 8 Marshalls Row, Open Market, Brighton & Hove, East Sussex, BN1 4JU

An exhibition specially for Heritage Open Days which focuses on the history of brewing in Lewes, East Sussex and its related industrial and agricultural links from the 18th Century to the present day, a period of some 200 years. The exhibition runs along these thematic lines:

Introduction
Breweries in decline
Hops and songs
Old breweries
Revival of micro breweries

Opening Times

Friday 9 September: 12.00 – 19.00

Saturday 10 September: 13.00 – 17.00

Ashcombe Toll House

*Ashcombe Roundabout on A27 (South Side),
Lewes, East Sussex*

This Toll House is the sole survivor of a pair that marked the beginning of the Brighton turnpike. It is on the south side of the A27 and was originally conceived as a store and shelter, the partner-building having accommodation for the turnpike keeper and his family. It was built circa 1820. The history of the toll house is of interest to young and old alike, as it yields an insight to travel in a bygone age.

Opening Times:

Saturday 10 September: 10.00 – 17.00

Sunday 11 September: 10.00 – 17.00

Foredown Tower Camera Obscura Demonstration

*Foredown Tower Countryside Centre,
Foredown Road, Portslade, Brighton & Hove,
East Sussex, BN41 2EW*

A hidden gem nestled on the edge of the South Downs, Foredown Tower fascinates adults and children alike. This iconic Edwardian water tower stands solid and proud in the skyline of Portslade Old Village. Set inside tall flint walls, the garden is notorious for its “Foredown wind”. Foredown Tower now features a “camera obscura” since 1991 – the largest in the South-East. Stay for a chat and a cup of tea or coffee with cakes and snacks in our very reasonably-priced cafe. Free parking. Cafe open 10.30am – 3.00pm

Opening Times:

Thursday 8 September: 11.00 – 11.30, 12.00 – 12.30, 13.00 – 13.30, 14.00 – 14.30

Saturday 10 September: 1100-1130, 1200-1230, 1300-1330, 1400-1430

Jill Windmill

*Near Clayton Village, Brighton & Hove, East
Sussex, BN6 9PG*

Jill Windmill is set in a beautiful location, high on the South Downs, but she is more than just a pretty sight. Jill is a fully restored Post Mill, originally built in Brighton in 1821 and moved to her present location in 1852.

Opening Times:

Sunday 11 September: 14.00 – 17.00

West Blatchington Windmill

*97 Holmes Avenue , Brighton & Hove, East
Sussex, BN3 7LE*

Unusual six sided smock mill c.1820, built on a square flint and brick tower. It was sketched by John Constable in 1825. Restored as a fascinating museum of milling and agricultural history with five floors to explore and many unique features to be seen.

Refreshments available to purchase in the north barn

Opening Times:

Sunday 11 September: 14.00 – 17.00

Booking required

Brighton Palace Pier History tour

*Brighton Pier, Madeira Drive, Brighton & Hove,
East Sussex, BN2 1TW*

The tour will consist of an engaging walk along the boardwalk and will cover the history of the pier including how parts of the previous Chain Pier were reused in the Palace Pier's construction. There will be a chance to see behind the scenes at parts of the pier not usually open to the public.

Opening Times:

Thursday 8 September: Tours: 13.00 – 14.00
and 16.00 – 17.00

Saturday 10 September: Tours: 13.00 – 14.00
and 16.00 – 17.00

Railway and Greenway – a guided walk from Brighton to London Road Station

*Meet at Cycle Hub, Brighton Station (North
entrance), Brighton & Hove, East Sussex*

Discover the industrial history behind the Brighton Greenway, find out more about the architectural diversity of Preston Circus, influenced by its role as a transport hub, and visit the back rooms and tiny gardens of one of Brighton's Victorian suburban stations: a celebration of railway and urban green space!

This event is Led by: Elspeth Broady and guests.

Opening Times:

Sunday 11 September: Walk 11.00 – 13.00

Shoreham Lifeboat Station Tour

*Royal National Lifeboat Institution, Lifeboat
House, Brighton Road, Shoreham-by-Sea,
West Sussex, BN43 6RN*

The present Shoreham Harbour Lifeboat station was completed in 2010 following the demolition of the old Lifeboat Station which

had stood on the same site since 1933. The new Lifeboat Station consists of a large boat hall, crew training room / class room, proper drying facilities for wet crew kit, changing facilities and a viewing platform, all of which will be open to the public during the Brighton Heritage Open days (subject to emergency operational requirements).

Thursday 8 September: 11.00 – 12.30

Friday 9 September: 11.00 – 12.30

Saturday 10 September: 11.00 – 12.30

Sunday 11 September: 14.00 – 15.30

Shoreham Port Tour

Meet: Nautilus House, 90-100 Albion Street, Brighton & Hove, East Sussex, BN42 4ED

Join Shoreham Port for a 'behind-the-scenes' tour visiting areas of the Port that are normally off-limits to the public. The coach tour will begin at the main Nautilus House office before proceeding to various locations around the Port where the group will be able to get off the coach and explore areas of interest in more detail.

Thursday 8 September: 14.30 – 16.00

The Fascinating Mr Ranger and Early British Concrete Heritage

Regency Town House, 13 Brunswick Square, Brighton & Hove, East Sussex, BN3 1EH

William Ranger was born in Ringmer, Sussex, at the end of the 18th century but spent many of his formative years in Brighton; where he worked with a young Charles Barry, then just embarking on his long architectural career. During this period, Ranger and Barry developed key local sites such as St Peter's Church and the Royal Sussex County Hospital. In almost all of his local works Ranger deployed his 'Artificial Stone', a product for which he subsequently acquired patents in 1832 and 1834. Join us for a 45 minute talk about this fascinating man.

Friday 9 September: 10.00 – 10.45

EDUCATION

Open Door - no booking required

Dr Samuel Johnson in Brighton

The Regency Town House, 13 Brunswick Square, Brighton & Hove, East Sussex, BN3 1EH

Dr Samuel Johnson is one of the most quoted writers in English and he was a formative influence on the Regency era and the British Enlightenment. He was famous for his quick wit, his lively conversation and his strong opinions. With a group of lexicographers he compiled a pioneering but quirky England dictionary. His friendship with Boswell is one of the most enduring and productive in British history. Dr Johnson visited Sussex regularly and, in this talk, historian James Simister will outline the importance of these visits to his health and to his work.

Opening Times:

Saturday: 10.00 – 11.00

Booking required

Brighton College Tour

Eastern Road, Brighton & Hove, East Sussex, BN2 0AL

The College is situated in the Kemp Town district to the east of Brighton. The early parts were designed by Sir Gilbert Scott, RA, 1848 to 1862.

Please note: The tour starts promptly and latecomers may not be able to join the tour.

Friday 9 September: 11.15 – 12.30

Directions:

Visitors should report to the Security Lodge at the main entrance on Eastern Road.

The Keep, home to the East Sussex Records Office: Behind the Scenes Tour

The Keep, Woollards Way, Brighton & Hove, East Sussex, BN1 9BP

Come to The Keep Archives for a behind-the-scenes tour! This state-of-the-art building is home to East Sussex Record Office, the Royal Pavilion & Museums local history collections, and the University of Sussex Special Collections, which includes the Mass Observation Archive. The tour itself usually lasts about 45 minutes and will end with the document display. Event not suitable for children under the age of 7.

Friday 9 September: 11.00 – 12.00 & 15.00 – 16.00

Directions:

We are situated on the edge of Brighton just off the A27 near to the University Campuses

and the Amex Stadium. Buses from Brighton and Lewes directions stop close to the building and we are just a 10 minute walk from Falmer train station. Please note that the postcode may not work with Sat Nav systems as it is relatively new but the geographic co-ordinates for the Keep are as follows: N 50°51.550' W 000°05.729' and TQ 32022 08239

GARDEN & NATURE

Open Door - no booking required

Saddlescombe Farm Tour

Saddlescombe Road, Brighton & Hove, East Sussex, BN45 7DE

Discover this ancient downland farm that was once owned by the Knights Templar. Enjoy tours of the 17th century Threshing Barn, Tudor Scullery and Donkey Wheel. Visit the Saddlescombe Learning Space which houses the Saddlescombe archaeological collection donated by the Brighton Museum. Refreshments at the wonderful Hiker's Rest cafe.

Opening Times:

Sunday 11 September: 10.30 – 15.30

Access Information:

Limited wheelchair access in buildings. Some tracks around the farm are challenging but should be manageable with the warden's assistance. Disabled toilet available at the Farm.

Whitehawk Hill Nature Reserve

Meet at Wyevale Garden Centre, situated on Warren Road (top of Elm Grove), Brighton & Hove, East Sussex, BN2 9XX

Join BHCC park ranger Paul for an exciting wander around the hidden gem that is Whitehawk Hill Nature Reserve. Discover the ancient Stone Age camp on top of the hill, which is much older than Stonehenge. Enjoy one of the city's richest wildlife sites, wading through wildflowers and butterflies. Walk around the newly established and hugely successful Race Hill Community Orchard. See our conservation grazing flock in action on the main hill or the Tenantry Down triangle.

Opening Times:

Sunday 11 September: Walk 12.00 – 14.30

ART & LITERATURE

Open Door - no booking required

The Aubrey Beardsley Tour

Meet at W H Smith's bookshop on the concourse of Brighton Station, Queens Road, Brighton & Hove, East Sussex, BN1 3XP

Join guide Alexia Lazou for a gentle 90-120 minute stroll through Brighton, exploring the buildings and places associated with the early life of artist Aubrey Beardsley (1872-1898), famous for his innovative black and white illustrations.

Opening Times:

Sunday 11 September: 11.00 – 12.00

THEATRE & CINEMA

Open Door - no booking required

Bardsley's of Baker Street, Max Miller Room

22-23A Baker Street, Brighton, Brighton & Hove, East Sussex, BN1 4JN

Bardsley's of Baker Street is a Brighton & Hove icon. A back-street fish and chip shop that regularly scoops top national rankings for the quality of its service and its servings. During Heritage Open Days why not pop along to the shop and see one local icon's acknowledgement to another by discovering the Max Miller Room. Developed in collaboration with the Max Miller Appreciation Society, the room contains original memorabilia, including one of the Cheeky Chappie's stage costumes. And why not stay and sample Brighton's finest fish and chips!

Opening Times:

Thursday 8 September: 12.30-15.00 & 17.00-20.30

Friday 9 September: 12.30-15.00 & 17.00-20.30

Saturday 10 September: 12.30-15.00 & 17.00-20.30

Nice Girls Didn't go to the Academy! Cinema Themed Guided Tour

STARTS - Duke of York's Cinema, Preston Circus, Brighton & Hove, East Sussex, BN1 4NA

Join Alexia Lazou as she leads you through the town centre, stopping at various former and current cinema sites, evoking the Golden Age of the Silver Screen. The guided tour will

end at The Melrose Restaurant at approximately 1930. The Melrose was formerly the Pandora Gallery, where the first films to be shown outside London were screened in 1896. Approximately 1.7 miles / 90 mins.

Friday 9 September: 18.00 – 19.30

Booking required

Duke of York's Cinema

Duke of York's Cinema, Preston Circus, Brighton & Hove, East Sussex, BN1 4NA

Visit Britain's longest surviving cinema, the Duke of York's, for a tour of this iconic landmark. The Duke of York's opened its doors on 22 September 1910.

Friday 9 September: 10.00 & 10.45

New Venture Theatre

Bedford Place, Brighton, BN1 2PT

Saturday 10th and Sunday 11th September 2016 - NVT Heritage Open Days

The New Venture Theatre (affectionately known as the 'NVT') is an amateur theatre which specializes in presenting high quality theatre productions with a particular focus on new dramatic writing. The NVT was founded in 1947 as the Brighton and Hove Repertory Company and, for many years, led a nomadic existence until it took a lease on the first floor of Christchurch Schoolrooms in Bedford Place in 1956.

Opening Times:

Saturday 10th September 10.30 – 17.00

Sunday 11th September: 10.30 – 17.00

Tours at 11.00, 12.00, 13.00, 14.30 both days

Theatre Royal Brighton Tour

New Road, Brighton & Hove, East Sussex, BN1 1SD

Step into the Theatre and be engulfed by the glamorous world of West End productions and stars of the stage. Creep behind the scenes of this theatrical treasure, steal a bow onstage like countless stars before you, sneak into the Queen's seat in the Royal Box, tip toe into the infamous 'gulp bar' used by Laurence Olivier and explore the unusual backstage area constructed from fishermen's cottages.

Meet in the Box Office entrance on New Road

Friday 9 September: 10.30

Saturday 10 September: 11.30

Brighton and Hove Open Door 2016

Post-war Brighton & Hove in film

The Regency Town House, 13 Brunswick Square, Brighton & Hove, East Sussex, BN3 1EH

Join us for the screening of a mid-20th century short film about the City (then two separate towns) by Brightonian John King. This event is provided courtesy of Screen Archive South East and will last approximately half an hour with Q&A session after the film.

Opening Times

Friday 9 September: 1500

ARCHAEOLOGY

Open Door - no booking required

Whitehawk Camp - Neolithic Causewayed Enclosure or Stone Age circle?

Meet at the corner of Manor Hill and Queensway, Brighton & Hove, East Sussex

Fed up with Regency architecture? Come along and explore the first visible enclosing of a large communal space in our region. Situated in a commanding position above East Brighton, close to the Race Course, lays one of Britain's earliest Stone Age monuments. The hill top here was chosen some 5,650 years ago as the site for a large ceremonial enclosure, an area for undertaking feasting, burials and communing.

Thursday 8 September: 18.00

Directions:

Meet: Corner of Manor Hill and Queensway (the roundabout at this point also connecting with Firle Road and Freshfield Road), Brighton at 17:55

Booking required

Ovingdean excavation site

Meet at entrance to Ovingdean Church (St Wulfran's), Greenways, Brighton & Hove, East Sussex, BN2 7BA

Join site director John Skelton for a tour of the church and site of the excavation of a medieval enclosure associated with the late Saxon and early Norman church. The field immediately north of St Wulfran's Church, Ovingdean is full of earthworks forming an enclosure.

Saturday 10 September: 12.00 – 12.45 & 14.00 – 14.45

ARCHITECTURE

Open Door - no booking required

Building the Denman Legacy

The Regency Town House, 13 Brunswick Square, Hove, Brighton & Hove, East Sussex, BN3 1EH

The Denman family, humble Sussex builders in the early-to-mid-19th century, rose to become amongst the most influential of local architectural clans during the 20th century. Today, almost all of us will fairly regularly negotiate our way through (and past) a wide variety of properties they have shaped. This small exhibition exposes and celebrates their contribution to the local townscape and will, hopefully, encourage a larger and more comprehensive presentation in the future. Event not suitable for children under 7.

Opening Times:
Friday 9 September: 14.00 – 16.00

Booking required

George Jackson and Sons - architectural ornamentalists

The Regency Town House, 13 Brunswick Square, Brighton & Hove, East Sussex, BN3 1EH

Visit our small exhibition about the firm of George Jackson & Sons Ltd. One hundred years ago, Jackson's were, without doubt, the country's greatest architectural ornamentalists. Today, the portion of the Jackson archive held at The Regency Town House is undergoing 3D scanning, in collaboration with a team from the University of Brighton. Event not suitable for children under the age of 7.

Opening Times:
Friday 9 September: 11.00 – 11.45

Maintaining your historic Brighton & Hove home

The Regency Town House, 13 , Brighton & Hove, East Sussex, BN3 1EH

Do you live in a local historic house? Then you likely spend quite a lot maintaining the property. But, are you getting good value for money and doing the right things to minimise outlay and maximise benefit. Are you helping yourself financially and helping the original fabric of your home survive into the future? If you are confused about historic property

maintenance, come along to our event focusing on the basics of good practice.

Opening Times:
Friday 9 September: 13.00 – 14.00

Plaster Ornament in Period Houses

The Regency Town House, 13 Brunswick Square, Brighton & Hove, East Sussex, BN3 1EH

Join us for a short presentation about how the ornamental plaster decorations in Regency and Victorian houses were made and fitted. Wear old clothes if you wish to participate. Duration approximately 45 minutes. Event not suitable for children under the age of 12.

Opening Times:
Friday 9 September: 12.00 – 12.45

ENDS

NOTES:

1) Where event pre-booking is required, this can be done via The Regency Town House website (www.rth.org.uk/BHOD16) or via 01273 206206.

2) This document provides a summary of the full online listings available via the website above.

3) Front cover image - courtesy of The Keep archives, East Sussex Record Office.